



Utva Silosi

POWERING TOMORROW

www.utva.rs

2026

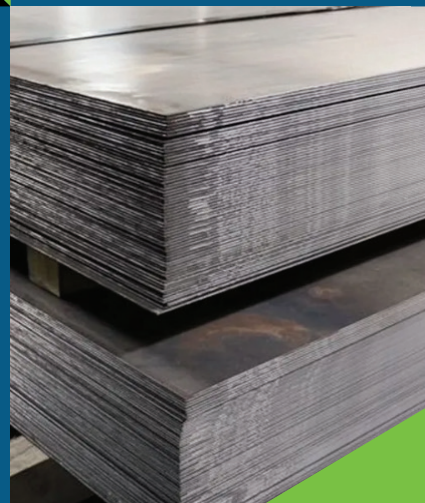



Utva Silosi a.d. Kovin se nalazi u Kovinu, Srbija.

Osnovana je 1979. godine, a od 1990. godine posluje samostalno.

Kompanija proizvodi cevi, profile, limove i mašine za sečenje.

Utva Silosi a.d. Kovin is placed in Kovin, Serbia.

It was established in 1979. and since 1990. operates independently.

Company produces tubes, profiles, sheets and slitters.



**POWERING
TOMORROW**



www.utva.rs

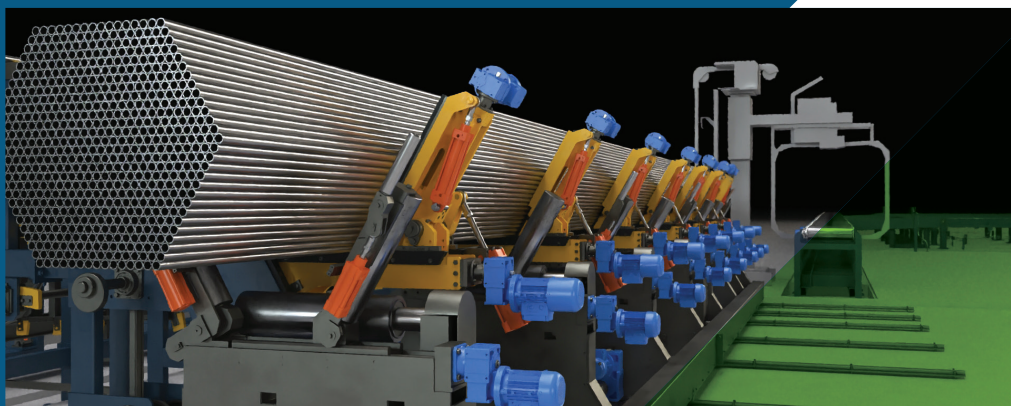

Toplovaljane čelične table Black steel sheets

Standardni program isporuke Standard delivery program



Debljina/Thickness (mm)	Masa/Weight (kg/m ²)	Dimenzije/Commercial sizes (mm)				
		1000x2000	1250x2500	1500x3000	1500x6000	2000x6000
1,5	11,8	☯	☯	/	/	/
2	15,7	☯	☯	☯	☯	/
2,5	19,6	☯	☯	☯	☯	/
3	23,6	☯	☯	☯	☯	/
4	31,4	☯	☯	☯	☯	☯
5	39,3	☯	☯	☯	☯	☯
6	47,1	☯	☯	☯	☯	☯
7	55,0	☯	☯	☯	☯	☯
8	62,8	☯	☯	☯	☯	☯
10	78,5	☯	☯	☯	☯	☯
12	94,2	☯	☯	☯	☯	☯

Izvodljiva dužina / Feasible length 500-12 000 mm

Standard proizvodnje/ Manufacturing standard	Opis proizvoda/ Product designation	Kvalitet/ Grade
EN 10025-2	Nelegirani konstrukcioni čelici/ Non-alloy structural steels	S235JR- S355J2
EN 10149-2	Toplo-valjani čelici visoke granice tečenja za hladno oblikovanje/ Hot-rolled high yield strenght steels for cold forming	S315MC- S460MC
EN 10111	Toplo-valjani niskougljenični čelici za hladno oblikovanje /Hot-rolled low carbon steels for cold forming	DD11 - DD14
EN 10028-2	Čelik za rad pod pritiskom (kotlovski)/ Steel for pressure purposes	P265GH

Uslovi isporuke / Supply conditions

Tolerancije dimenzija prema EN 10051

Dimensional tolerances according to EN 10051

Specijalne tolerancije prema zahtevu / Special tolerance upon request

Toplovaljane rebraste (reljefne-"suza" i "Romb") čelične table Teardrop and patterned steel sheets

Standardni program isporuke Standard delivery program

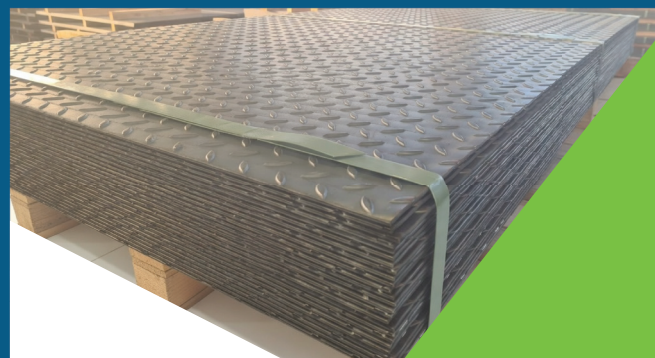

Toplovaljane rebraste (reljefne-"suza") čelične table Teardrop patterned steel sheets

Debljina/Thickness (mm)	Masa/Weight (kg/m ²)	Dimenzije/Commercial sizes (mm)			
		1000x2000	1250x2500	1500x3000	1500x6000
3	26,1				
4	33,9				
5	41,8				
6	49,6				
8	65,3				
10	81,0				
Izvodljiva dužina / Feasible length 500-12 000 mm					



Toplovaljane rebraste (reljefne-"Romb") čelične table Diamond patterned steel sheets

Debljina/Thickness (mm)	Masa/Weight (kg/m ²)	Dimenzije/Commercial sizes (mm)			
		1000x2000	1250x2500	1500x3000	1500x6000
3	27,2				
4	35,1				
5	43,0				
6	51,0				
8	65,3				
Izvodljiva dužina / Feasible length 500-12 000 mm					

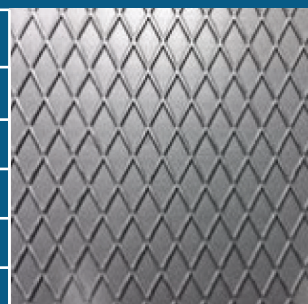

Standard proizvodnje/ Manufacturing standard	Opis proizvoda/ Product designation	Kvalitet/ Grade
EN 10025-2	Nelegirani konstrukcioni čelici/ Non-alloy structural steels	S235JR :3-10mm S275JR :3-6mm

Uslovi isporuke / Supply conditions

Tolerancije dimenzija i oblika prema DIN 59220 /STAS 3480 (izuzimajući kritične dimenzije, ravnost rebrastih proizvoda se garantuje po EN 10051)

Dimensional tolerances and shapes according to DIN 59220 /STAS 3480 (excluding critical dimensions, flatness of patterned products is guaranteed to EN 10051)

Specijalne tolerancije prema zahtevu / Special tolerance upon request

Hladnovaljane table od niskougleničnih čelika

Cold-rolled steel plates made of low-alloy sheets

Standardni program isporuke Standard delivery program



Debljina/Thickness (mm)	Masa/Weight (kg/m ²)	Dimenzije/Commercial sizes (mm)		
		1000x2000	1250x2500	1500x3000
0,4	3,1	☯	/	/
0,5	3,9	☯	☯	/
0,6	4,7	☯	☯	/
0,7	5,5	☯	☯	☯
0,8	6,3	☯	☯	☯
0,9	7,1	☯	☯	/
1	7,9	☯	☯	☯
1,2	9,4	☯	☯	☯
1,5	11,8	☯	☯	☯
2	15,7	☯	☯	☯
2,5	19,6	☯	☯	☯
3	23,6	☯	☯	☯
Izvodljiva dužina / Feasible length 500-4000 mm				

Standard proizvodnje/ Manufacturing standard	Opis proizvoda/ Product designation	Kvalitet/ Grade
EN 10130	Hladnovaljani ravni proizvodi od niskougleničnog čelika za hladno oblikovanje /Cold rolled low carbon steel flat products for cold forming	DC01; DC03; DC04; DC05; DC06

Uslovi isporuke / Supply conditions

Tolerancije dimenzija i oblika prema EN10131

Dimensional tolerances and shapes according to EN 10131

Specijalne tolerancije prema zahtevu /

Special tolerance upon request

ČELIČNE CEVI SA ŠAVOM HLADNO OBLIKOVANE OKRUGLOG PRESEKA WELDED STEEL TUBES WITH SEAM CIRCULAR HOLLOW SECTION

Isporučuju se prema standardu / Delivered according to

**STANDARD ZA KVALITET
QUALITY STANDARD**

EN10025-2

S235JR

S275JR

S355J2

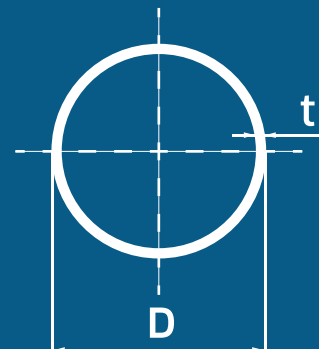

EN 10219-2 Hladno oblikovani šuplji profili za čelične konstrukcije iz nelegiranih i finozičnih čelika za konstrukcije. Deo 2.Odstupanja dimenzija,dimenzije i karakteristike profila
EN 10219-2 Cold rolled hollow sections for steel structures from alloy and fine grain structure steel. Part 2. Dimension deviation, Dimension and characteristics of the profile

Dužina / Length: 4000-8000 mm

Δ Dužina / Length: 4000-12000 mm

ASORTIMAN OKRUGLIH ŠAVNIH CEVI/ CIRCULAR HOLLOW SECTIONS PRODUCT RANGE

Spoljašnji prečnik(mm)/ Outer diameter(mm)	Debljina zida cevi (mm) (t)/Wall thickness (mm)					
	1,5	2	2,5	3	4	5
	Podužna masa(kg/m)/Longitudinal mass (kg/m)					
Ø16	0,54	0,69				
Ø17,2	0,58	0,74				
Ø20	0,68	0,89				
Ø21,3	0,72	0,95	1,16			
Ø22	0,76	0,99				
Ø25	0,87	1,13	1,39			
Ø26,9	0,94	1,23	1,50	1,77		
Ø28	0,98	1,28	1,57			
Ø30	1,05	1,38	1,70			
Ø32	1,13	1,48	1,82			
Ø33,7	1,17	1,56	1,92	2,27		
Ø38	1,35	1,78	2,19	2,59		
Ø40	1,42	1,87	2,31	2,74		
Ø42,4	1,50	1,99	2,46	2,91		
Ø45	1,61	2,12	2,62	3,11		
Ø48,3 Δ	1,72	2,28	2,82	3,35	4,37	
Ø50 Δ	1,79	2,37	2,93	3,48		
Ø54	1,94	2,56	3,20			
Ø56	2,02	2,66	3,30			
Ø57 Δ	2,05	2,71	3,36	4,00	5,23	
Ø60,3 Δ	2,18	2,88	3,56	4,24	5,55	6,82
Ø63,5 Δ		3,03	3,72	4,48	5,87	7,21
Ø70 Δ	2,53	3,35	4,16	4,96	6,51	8,01
Ø76,1 Δ	2,76	3,65	4,54	5,41	7,11	8,77
Ø88,9 Δ		4,29	5,33	6,36	8,38	10,3
Ø101,6 Δ		4,91	6,11	7,29	9,63	11,90
Ø108 Δ		5,23	6,50	7,77	10,30	12,7
Ø114,3 Δ			6,89	8,23	10,90	13,50
Ø127 Δ			7,68	9,17	12,10	15
Ø133 Δ			8,05	9,62	12,70	15,80
Ø139,7 Δ				10,10	13,40	16,60
Ø159 Δ				10,50	15,30	19,00

ČELIČNE CEVI SA ŠAVOM HLADNO OBLIKOVANE KVADRATNOG PRESEKA WELDED STEEL TUBES WITH SEAM SQUARE HOLLOW SECTION

Isporučuju se prema standardu / Delivered according to

**STANDARD ZA KVALITET
QUALITY STANDARD**

EN10025-2

S235JR

S275JR

S355J2

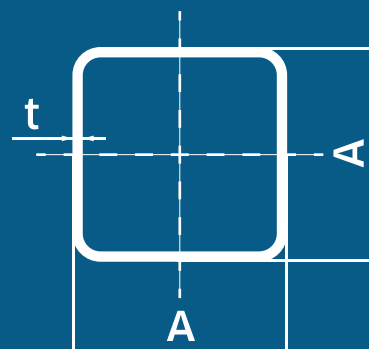

EN 10219-2 Hladno oblikovani šuplji profili za čelične konstrukcije iz nelegiranih i finostrukturnih čelika za konstrukcije. Deo 2. Odstupanja dimenzija, dimenzije i karakteristike profila
EN 10219-2 Cold rolled hollow sections for steel structures from alloy and fine grain structure steel. Part 2. Dimension deviation, Dimension and characteristics of the profile

*EN 10305-3 Dužina / Length: 4000-8000 mm

Δ Dužina / Length: 4000-12000 mm

ASORTIMAN KVADRATNIH ŠAVNIH CEVI/ SQUARE HOLLOW SECTIONS PRODUCT RANGE

Stranice cevi AxA (mm)/ Dimensions AxA (mm)	Debljina zida cevi (mm) (t)/Wall thickness (mm)					
	1,5	2	2,5	3	4	5
AxA	Podužna masa(kg/m)/Longitudinal mass (kg/m)					
13x13	0,54	0,65				
15x15	0,59	0,74				
16x16	0,64	0,85				
18x18	0,73	0,92				
20x20	0,83	1,05	1,25			
25x25	1,06	1,36	1,64			
30x30	1,30	1,68	2,03	2,36		
35x35	1,53	1,99	2,42	2,83		
40x40* Δ	1,77	2,31	2,82	3,30	4,20	
45x45* Δ	2,00	2,62	3,21	3,77	4,83	
50x50* Δ	2,24	2,93	3,60	4,25	5,45	6,56
60x60* Δ	2,71	3,56	4,39	5,19	6,71	8,13
70x70* Δ	3,18	4,19	5,17	6,13	7,97	9,70
80x80* Δ		4,82	5,96	7,07	9,22	11,30
90x90* Δ		5,45	6,74	8,01	10,50	12,80
100x100* Δ			7,53	8,96	11,70	14,40
110x110* Δ				9,90	13,00	16,00
120x120* Δ				10,80	14,20	17,50

ČELIČNE CEVI SA ŠAVOM HLADNO OBLIKOVANE PRAVOUGAONOG PRESEKA WELDED STEEL TUBES WITH SEAM RECTANGULAR HOLLOW SECTION

Isporučuju se prema standardu / Delivered according to

STANDARD ZA KVALITET
QUALITY STANDARD

EN10025-2

S235JR

S275JR

S355J2

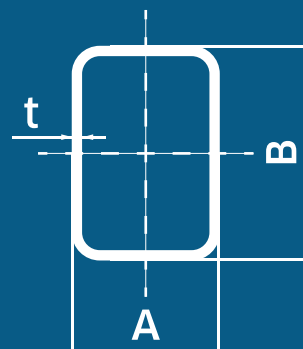

EN 10219-2 Hladno oblikovani šuplji profili za čelične konstrukcije iz nelegiranih i fino zrnih čelika za konstrukcije. Deo 2. Odstupanja dimenzija, dimenzije i karakteristike profila
EN 10219-2 Cold rolled hollow sections for steel structures from alloy and fine grain structure steel. Part 2. Dimension deviation, Dimension and characteristics of the profile

*EN 10305-3 Dužina / Length: 4000-8000 mm
Δ Dužina / Length: 4000-12000 mm

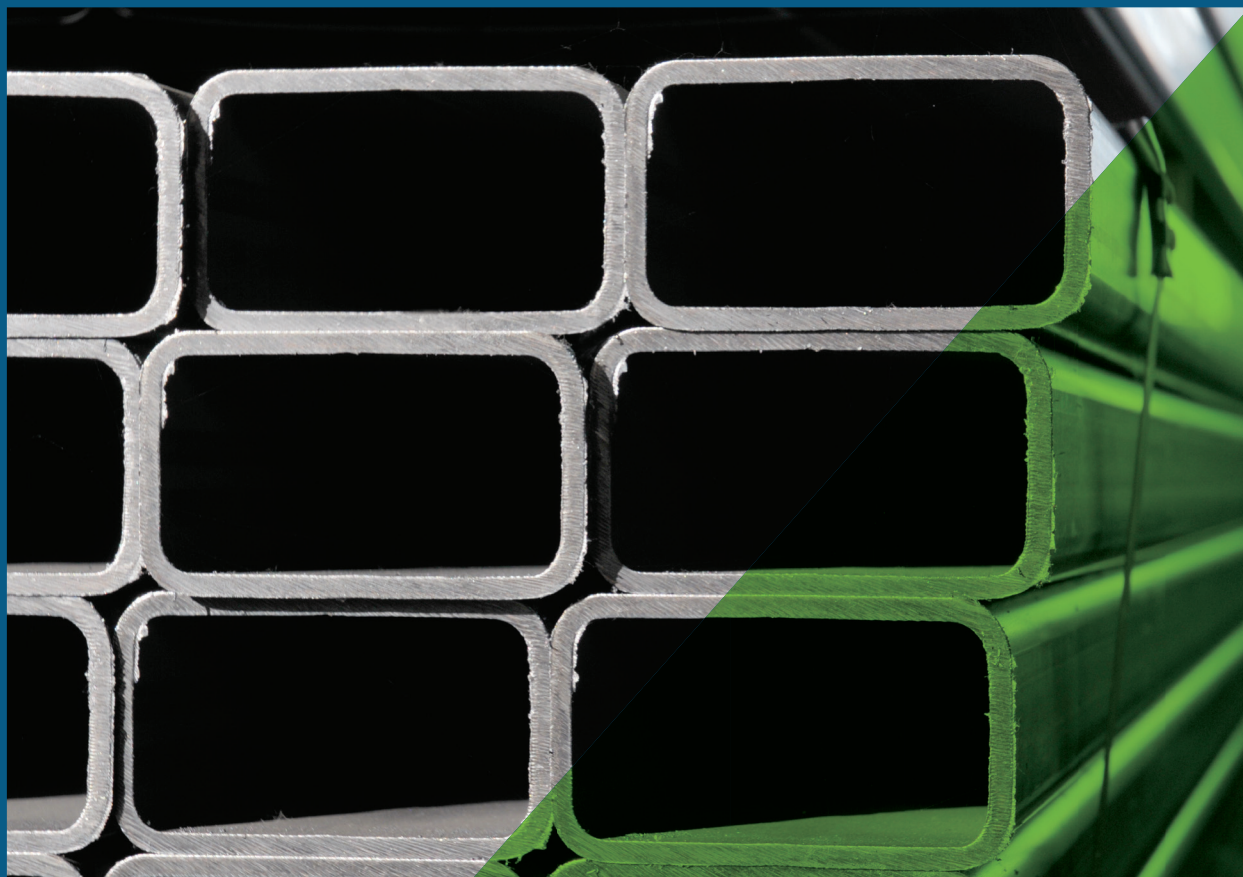

**ASORTIMAN PRAVOUGAONIH ŠAVNIH CEVI/
RECTANGULAR HOLLOW SECTIONS PRODUCT RANGE**

Stranice pravougaone(mm)/ Dimensions(mm)	Debljina zida(mm) (t)/Wall thickness (mm)					
	1,5	2	2,5	3	4	5
A x B	Podužna masa(kg/m)/Longitudinal mass (kg/m)					
15x10	0,46					
20x10	0,59	0,74				
20x15	0,71	0,89				
25x15	0,83	1,05	1,25			
30x15	0,94	1,21	1,44			
30x20	1,06	1,36	1,64			
30x25	1,18	1,52	1,84			
35x25	1,30	1,68	2,03	2,36		
40x10	1,06	1,36	1,64			
40x15	1,18	1,52	1,84			
40x20	1,30	1,68	2,03	2,36		
40x25	1,41	1,83	2,23	2,60		
40x30	1,53	1,99	2,42	2,83		
40x35	1,65	2,15	2,62	3,07		
50x15	1,41	1,83	2,23			
50x20	1,53	1,99	2,42	2,83		
50x25	1,65	2,15	2,62	3,07		
50x30* Δ	1,77	2,31	2,82	3,30	4,20	
50x35	1,89	2,46	3,01			
50x40* Δ	2,00	2,62	3,21	3,77	4,83	
60x20 Δ	1,77	2,31	2,82	3,30		
60x30* Δ	2,00	2,62	3,21	3,77	4,83	
60x35	2,12	2,78	3,41	4,01		
60x40* Δ	2,24	2,93	3,60	4,25	5,45	6,56
70x30* Δ	2,24	2,93	3,60	4,25	5,45	
70x40* Δ	2,47	3,25	3,99	4,72	6,08	
70x50* Δ	2,71	3,56	4,39	5,19	6,71	8,13
80x30 * Δ	2,47	3,25	3,99	4,72	6,08	
80x40 * Δ	2,71	3,56	4,39	5,19	6,71	8,13
80x60 * Δ	3,18	4,19	5,17	6,13	7,97	9,70
90x50 * Δ	3,18	4,19	5,17	6,13	7,97	9,70
90x60 * Δ		4,50	5,56	6,60	8,59	10,50
100x40* Δ	3,18	4,19	5,17	6,13	7,97	9,70
100x50 * Δ	3,42	4,50	5,56	6,06	8,59	10,50
100x60 * Δ		4,82	5,96	7,07	9,22	11,30
100x80 * Δ		5,45	6,74	8,01	10,50	12,80
110x60 * Δ		5,13	6,35	7,54	9,85	12,10
120x30* Δ		4,50	5,56	6,60	8,59	
120x40* Δ		4,82	5,96	7,07	9,22	11,30
120x50* Δ		5,13	6,35	7,54	9,85	12,10
120x60* Δ		5,45	6,74	8,01	10,50	12,80
120x80* Δ			7,53	8,96	11,70	14,40
120x100* Δ			8,31	9,90	13,00	16,00
140x40* Δ		5,45	6,74	8,01	10,50	12,80
140x60* Δ			7,53	8,96	11,70	14,40
140x70* Δ			7,92	9,43	12,40	15,20
140x80* Δ			8,31	9,90	13,00	16,00
140x100* Δ				10,80	14,20	17,50
150x40* Δ				8,48	11,10	13,60
150x50* Δ			7,53	8,96	11,70	14,40
160x60* Δ				9,90	13,00	16,00
160x80* Δ				10,80	14,20	17,50

HLADNO OBLIKOVANI / VALJANI PROFILI (OTVORENI PROFILI) COLD SHAPED/ROLLED SECTIONS (OPEN PROFILES)

**Proizvodnja hladno valjanih / oblikovanih profila od trake i od limova
u sledećim oblicima: L, U, C, Z, Ω .**

*Producing cold rolled/shaped profiles from strip and from sheets
in following shapes L; U; C; Z; Ω .*

**Maksimalna debljina hladno valjanih profila iznosi 6 mm,
uz maksimalnu dužinu do 12.000 mm**

*Maximum thickness for cold rolled profile is 6 mm
with length up to 12000 mm*

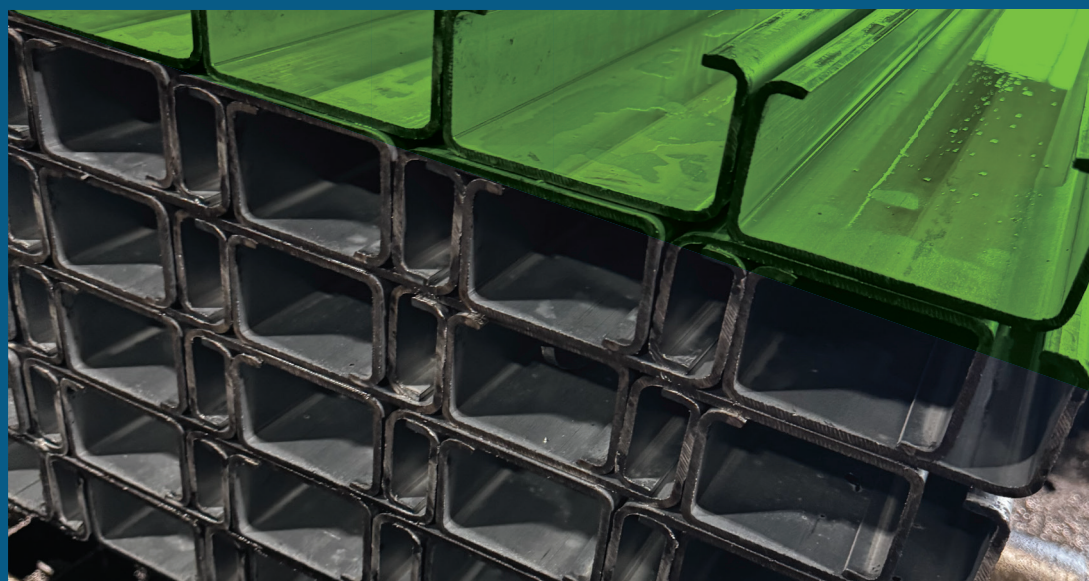

**Maksimalna debljina hladno oblikovanih profila iznosi 12 mm,
uz maksimalnu dužinu do 8.000 mm.**

*Maximum thickness for cold shaped profile is 12 mm
with length up to 8000 mm.*

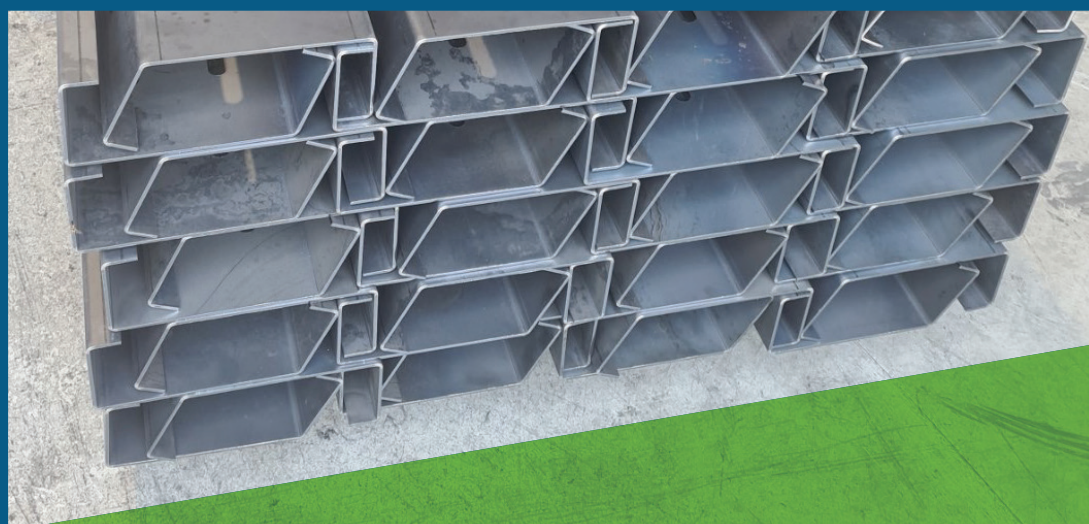

FIBER LASER ZA SEČENJE LIMA **FIBER LASER FOR SHEET**

Dimenzije radnog stola: 2000 × 8000 mm

Table dimension: 2000 × 8000 mm

Maksimalna debljina sečenja: do 15 mm

Max. cutting thickness up to 15 mm

FIBER LASER ZA SEČENJE CEVI **FIBER LASER FOR TUBES**

Dimenzije radnog stola: 20x20-120x120 mm

Table dimension: 20x20-120x120 mm

Maksimalna debljina sečenja: do 6 mm

Max. cutting thickness up to 6 mm



SPECIJALNI PROFILI SPECIAL PROFILES

Materijal / Material
S235JR:EN10025

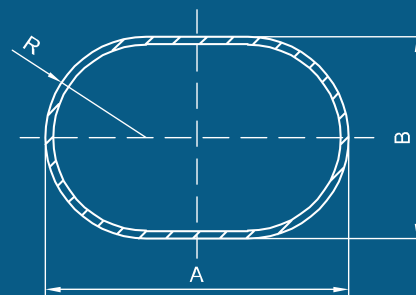

Oblik, dimenzije i mere definisane su za svaki tip profila za gradevinsku bravariju.
Proizvodne dužine profila iznose 4000 do 8000 mm.

Shape and dimensions are defined for each type of zp profile.
Length are from 4000 to 8000 mm.

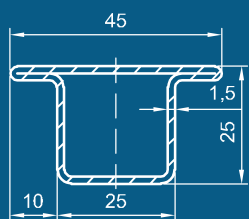

ZP 2004.....m=1.62 kg/m

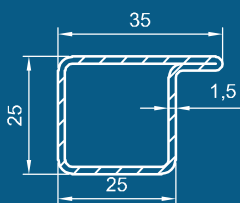

ZP 2304.....m=1.39 kg/m

Stranice ovalne cevi (mm) Dimension (mm)		Stranice ovalne cevi (mm) / Dimension (mm)		
		1.50	1.80	2.00
A	B	Podužna masa(kg/m) / Longitudinal mass (kg/m)		
30	15	0.91	1.08	/
32	18	0.99	1.19	1.31
38	20	1.18	1.41	1.56
50	30	1.59	1.90	2.10

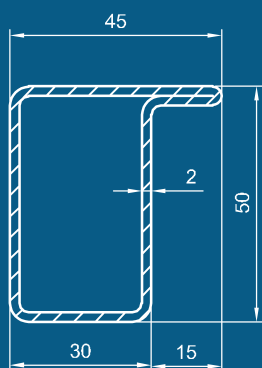

ZP 1321.....m=2.99 kg/m

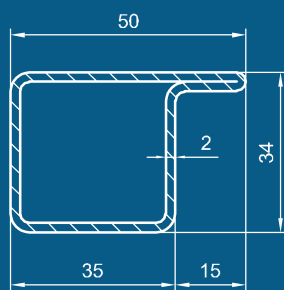

ZP 1304.....m=2.62 kg/m

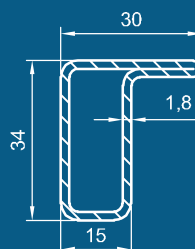

ZP 3304.....m=1.77 kg/m

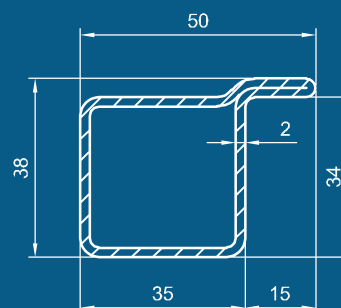

ZP 1804.....m=2.77 kg/m

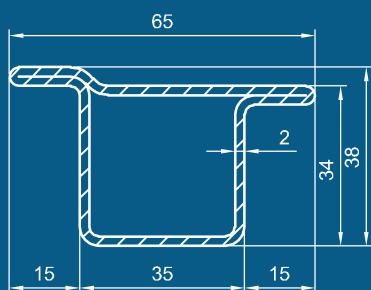

ZP 1104.....m=3.2 kg/m

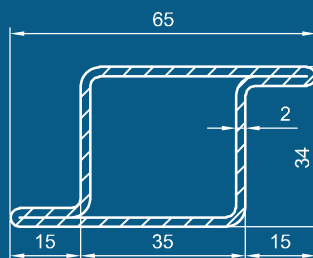

ZP 1704.....m=3.09 kg/m

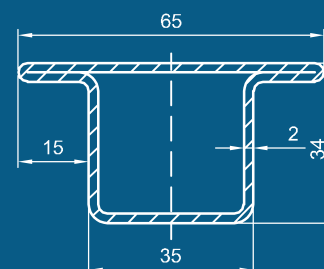

ZP 1004.....m=3.09 kg/m

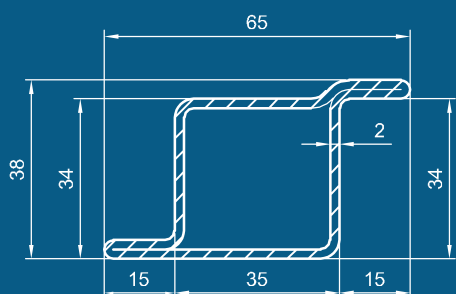

ZP 1204.....m=3.2 kg/m

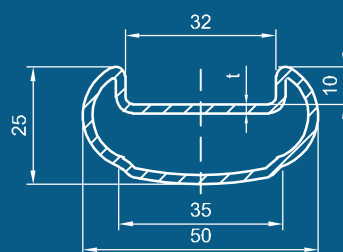

Rukohvat RU30

Naziv profila Profile name	Debljina trake Thickness mm	
	t=1.8	t=2
RU30	Težina kg/m Weight kg/m	
	2.15	2.38

SERTIFIKATI CERTIFICATES

Environmental Product Declaration



In accordance with ISO 14025:2006 and EN 15804:2012+A2:2019/AC:2021 for:

Sheet metal – cold rolled

from

UTVA SILOSI a.d. Kovin



Programme:	The International EPD System, www.environdec.com
Programme operator:	EPD International AB
Type of EPD:	EPD of a single product from a manufacturer
EPD registration number:	EPD-IES-0027839:001
Version date:	2025-12-22
Validity date:	2030-12-21
<small>An EPD may be updated or republished if conditions change. To find the latest version of the EPD and to confirm its validity, see www.environdec.com</small>	



Environmental Product Declaration



In accordance with ISO 14025:2006 and EN 15804:2012+A2:2019/AC:2021, of multiple products:

Sheet metal – hot rolled and Steel Strip

from

UTVA SILOSI a.d. Kovin



Programme:	The International EPD System, www.environdec.com
Programme operator:	EPD International AB
Type of EPD:	EPD of multiple products, based on the average results of the product group
EPD registration number:	EPD-IES-0027840:001
Version date:	2025-12-22
Validity date:	2030-12-21
<small>An EPD may be updated or republished if conditions change. To find the latest version of the EPD and to confirm its validity, see www.environdec.com</small>	



Environmental Product Declaration



In accordance with ISO 14025:2006 and EN 15804:2012+A2:2019/AC:2021 for:

Cold formed welded tubes

from

UTVA SILOSI a.d. Kovin



Programme:	The International EPD System, www.environdec.com
Programme operator:	EPD International AB
Type of EPD:	EPD of a single product from a manufacturer
EPD registration number:	EPD-IES-0027816:001
Version date:	2025-12-22
Validity date:	2030-12-21
<small>An EPD may be updated or republished if conditions change. To find the latest version of the EPD and to confirm its validity, see www.environdec.com</small>	



sertifikati
certificates

**POWERING
TOMORROW**
2026

Dahop[®]

Dahop UTVA doo nudi razne dimenzije toplo pocinkovanih traka za uzemljenje (od 20 do 50 mm širine i od 2 do 5 mm debljine po želji kupca), toplo pocinkovane žice debljine 8mm i 10mm u prečniku, napravljene od najkvalitetnijeg materijala za izradu čelika (S235JRG čelika), u skladu sa EN 62561-2, min 350gr - 470gr / mm² sloja cinka, po konkurentnim cenama za naše proizvode.

Toplo pocinkovana čelična traka i žica se obično koriste u elektro i građevinskoj industriji kao gromobranski provodnici (nadzemnih vodova, podzemnih vodova, elektro oprema, gasovoda ili naftovoda, zgrada..)

Kako bi se osigurala stabilnost kvaliteta u procesu proizvodnje, prodaje i komercijale, kompanija Dahop UTVA doo Aleksinac je organizovala i uskladila svoje poslovanje u skladu s međunarodnim standardom ISO 9001.

Dahop Utva d.o.o. offers a variety of sizes of Hot Dip Galvanized Earthing Strip (20 to 50mm width and from 2 up to 5mm thickness per customer request), and HDG wire in thickness of 8mm and 10mm in diameter, made out of best construction steel quality materials (S235JRG steel), according to EN 62561-2, min 350gr - 470gr / mm² Zinc layer at competitive prices for our products.

Hot dip galvanized steel strip and wire is commonly used by electro and building industries, usually as lightning ground conductors (overhead power lines, ground power lines, electro equipment, gas or oil pipelines, buildings..)

In order to ensure the stability of quality in production process, sales and commercial, company Dahop Utva d.o.o. Aleksinac organized its operations in accordance with international standard ISO 9001.

- HOT DIP GALVANIZED STEEL STRIP
- HOT DIP GALVANIZED STEEL WIRE
- ALMGSI WIRE

www.dahop-utva.com



sertifikati
certificates

TOPLO POCINKOVANA TRAKA HOT DIP GALVANIZED STEEL STRIP

ASORTIMAN H.D.G. STRIP	Thickness (mm)						
	2,0	2,5	3,0	3,5	4,0	5,0	6,0
Width (mm)	Weight (kg/m)						
20	0,319	0,400	0,484	0,567	0,650	0,800	
25	0,400	0,504	0,607	0,710	0,800	1,000	
30	0,484	0,607	0,731	0,845	0,968	1,215	
35	0,567	0,710	0,845	0,990	1,133	1,420	
40	0,650	0,803	0,968	1,133	1,298	1,620	
45	0,731	0,906	1,091	1,277	1,453	1,825	
50	0,800	1,009	1,215	1,420	1,620	2,020	2,420

Standard coil weight: 50 kg (+/-3 kg); om custom order from 20-25 kg to 50 kg (+/- 3 kg)



TOPLO POCINKOVANA ŽICA HOT DIP GALVANIZED STEEL WIRE

ASORTIMAN H.D.G. STRIP	Weight (kg/m)			
Ø 8	0,413			
Ø 10	0,638			

Standard coil weight: 50 kg (+/-3 kg); om custom order from 20-25 kg to 50 kg (+/- 3 kg)





**POWERING
TOMORROW**
2026



www.utva.rs
tube@utva.rs

Utva Silosi a.d. Kovin
Dunavska 46,
26220 Kovin,
Serbia